



Dominator Exhaust System Installation Instructions

For the:

HONDA CRF 1100L Africa Twin (SD08/SD09) (2020-)

Exhaust Valve & Stock Muffler Removal

- 1) The exhaust valve's servo in Honda CRF 1100L Africa Twin is located in the central section of the motorbike (marked place in the picture)



- 2) Unscrew marked bolt and carefully slide plastic heat shield off the motorcycle in marked direction

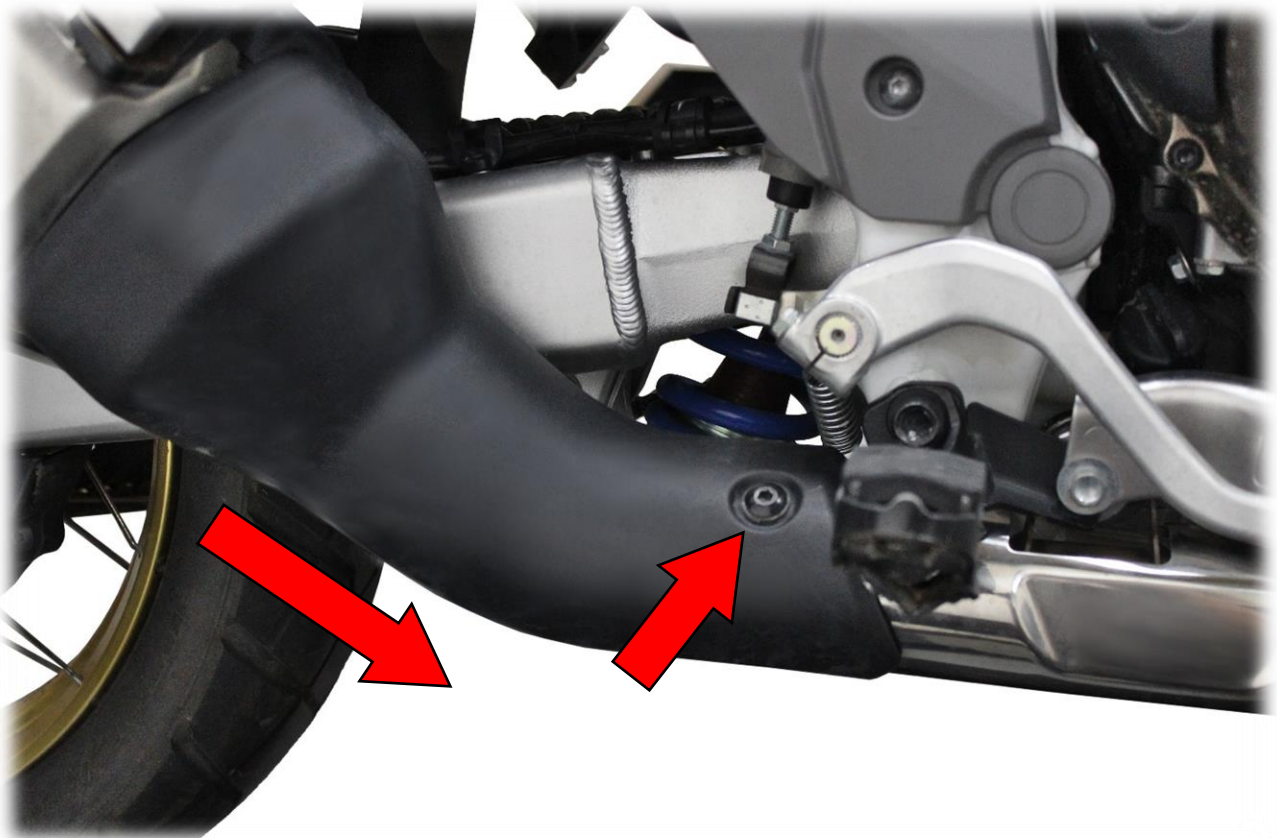

3) Unscrew marked bolts and remove the aluminium muffler heat shield

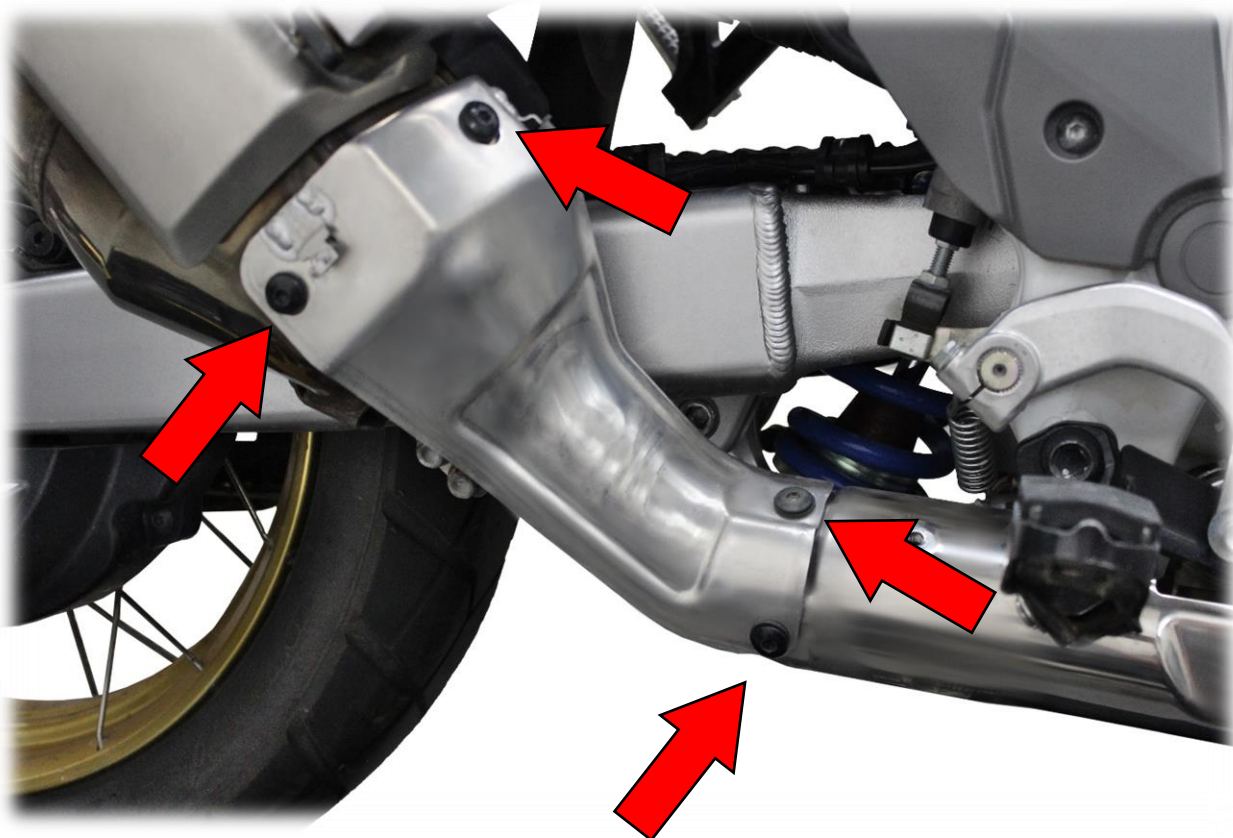

4) Remove right passenger foot peg (bolts located in marked places)

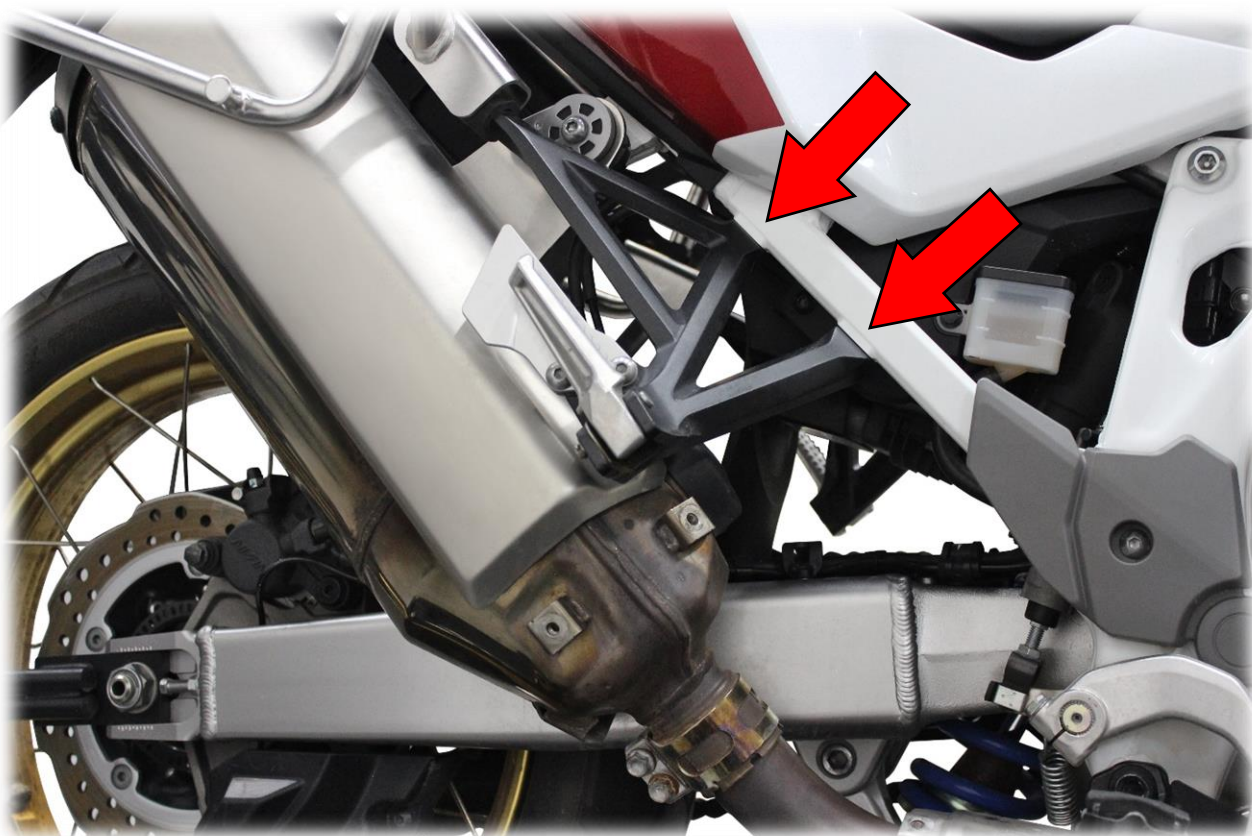

5) Unscrew marked bolts and remove the exhaust valve plastic cover

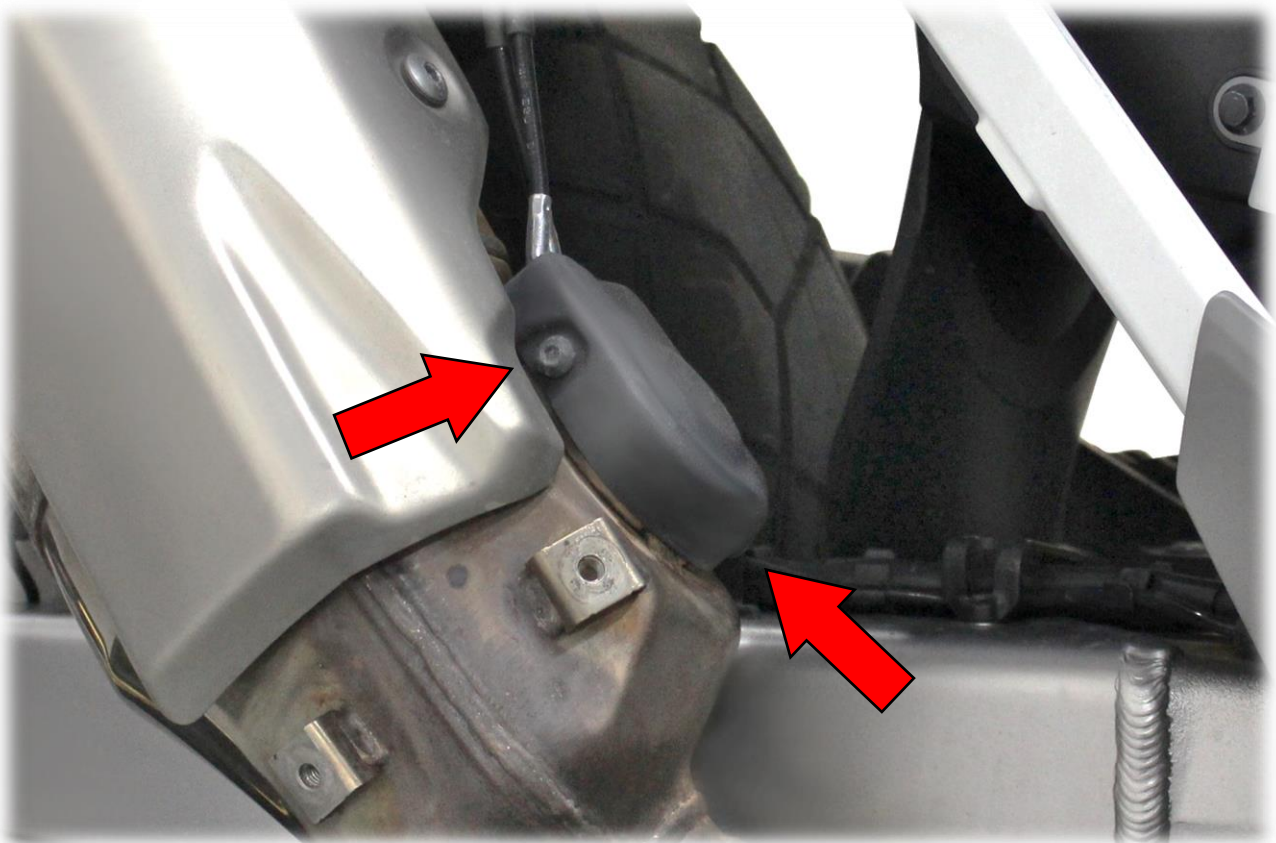

6) Untighten marked nuts and remove cables off the exhaust valve



7) Untighten marked clamp bolts, unscrew the muffler's bracket bolt and remove stock muffler off the motorcycle



8) Undo marked plastic fasteners, unscrew marked bolts and remove plastic mudguard

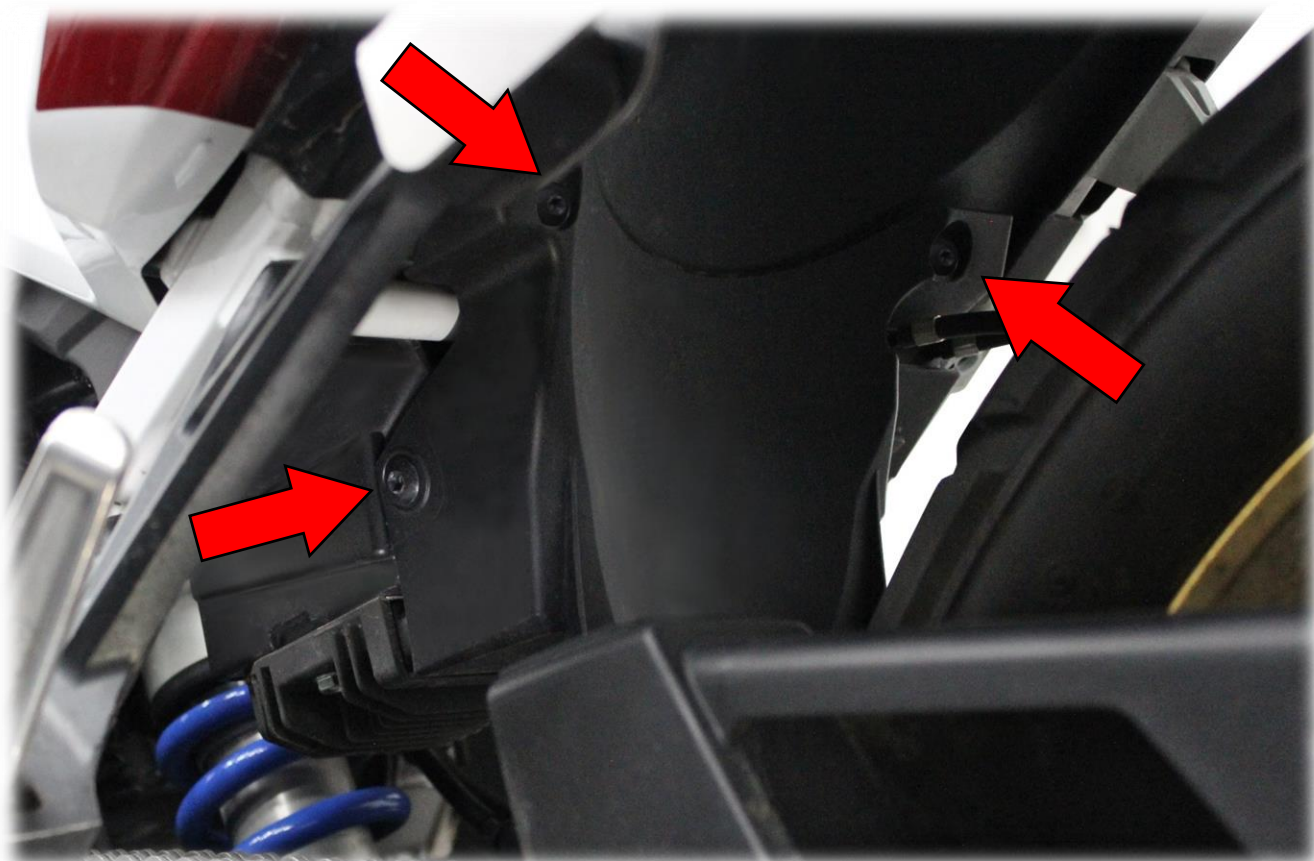
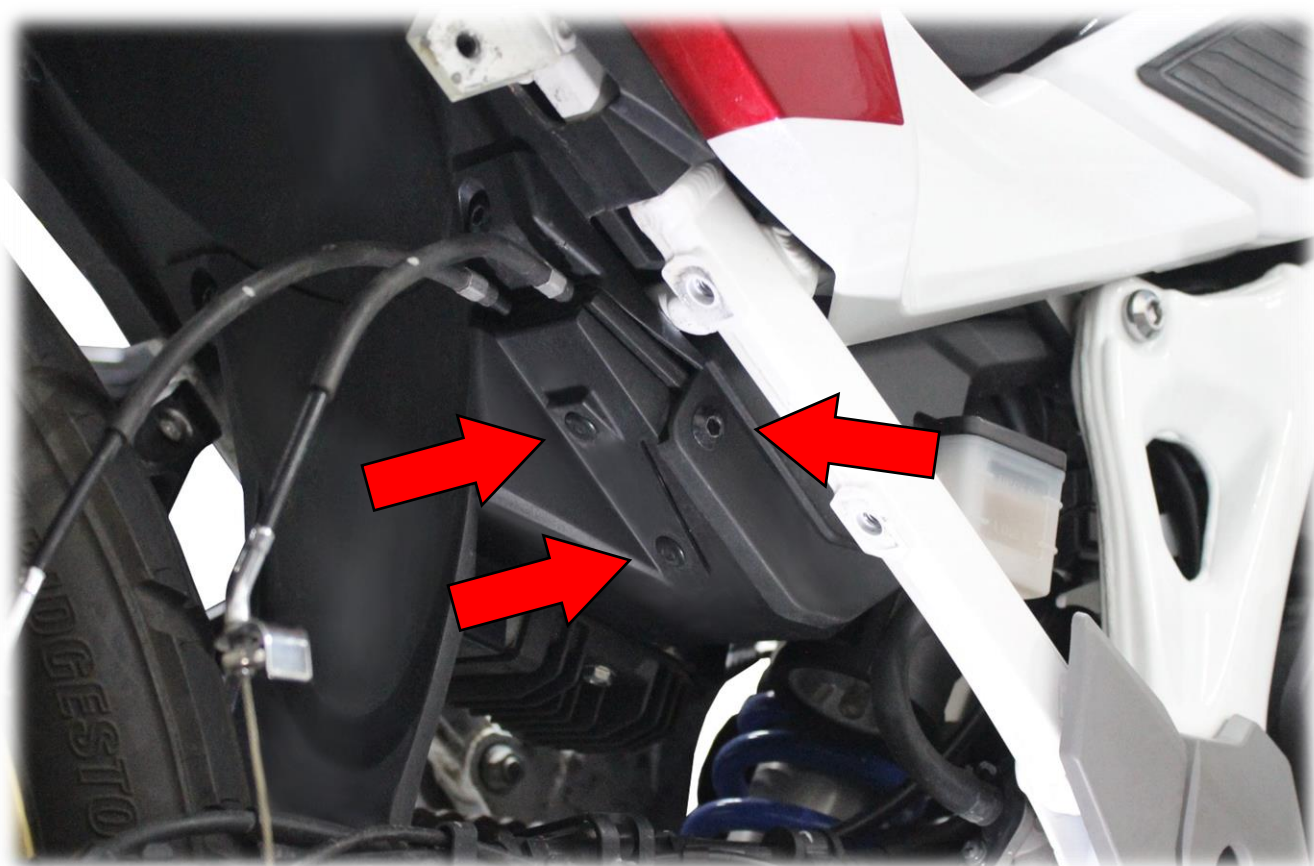

9) Unscrew rear brake fluid reservoir (marked bolt)



10) Undo the marked plastic fastener and remove the exhaust valve's servo off the motorcycle



11) Disconnect the exhaust valve's servo connector then unscrew marked bolts and remove the plastic cover off the servo motor

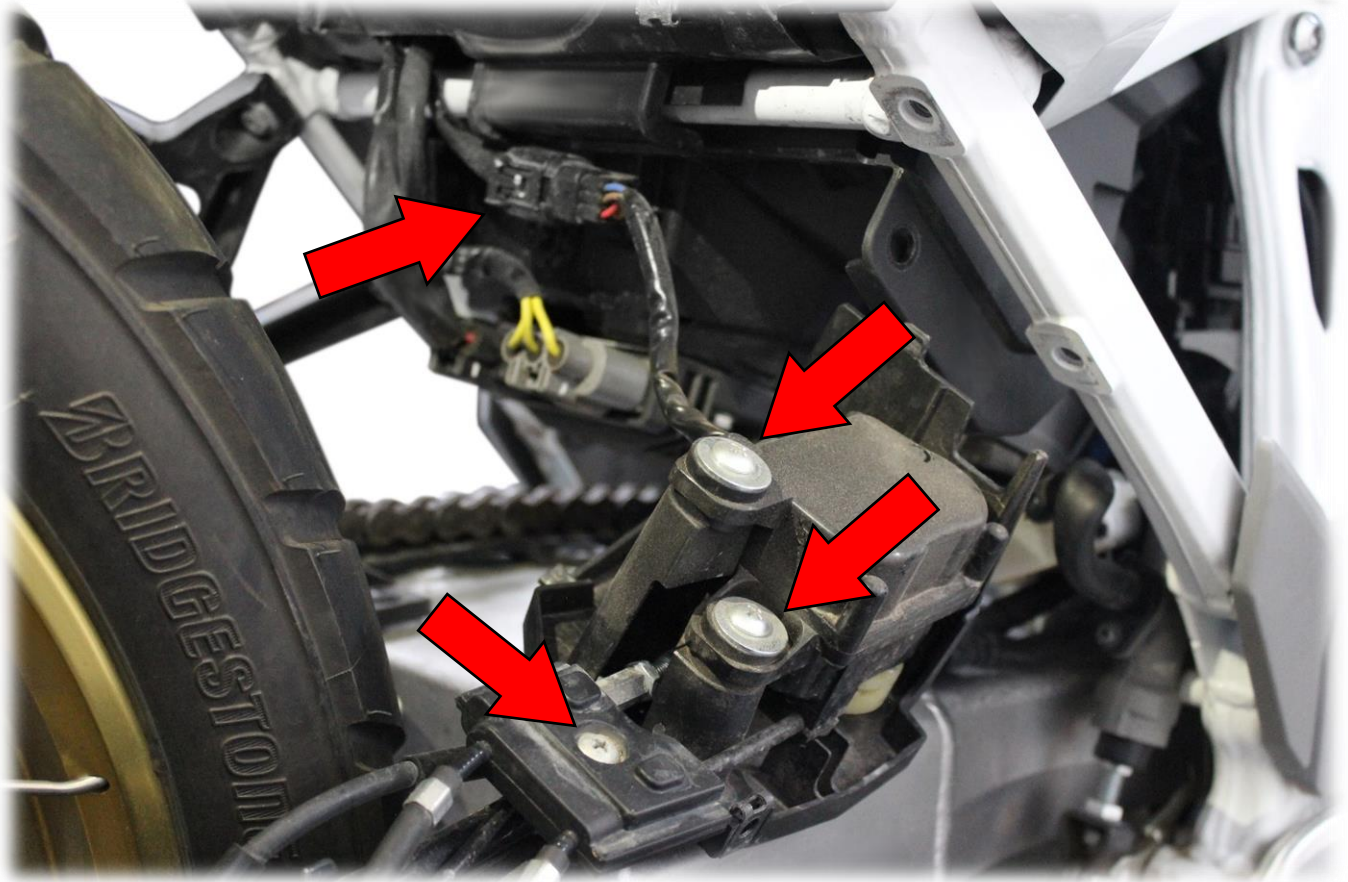

12) Connect exhaust servo eliminator dedicated to Honda CRF 1100L with the exhaust valve's servo connector

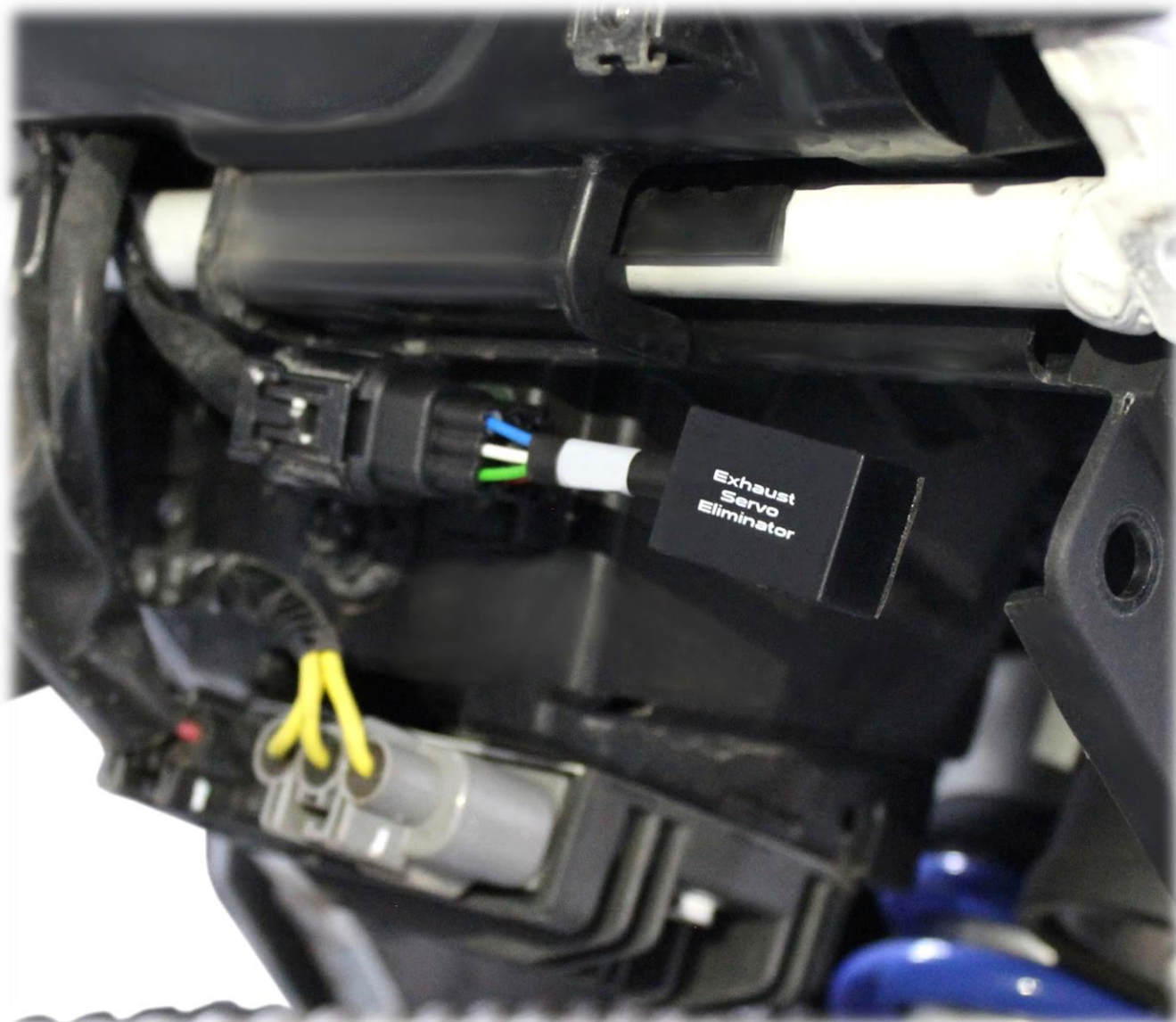

Warning! The exhaust servo eliminator is not included in the set, you must purchase it yourself. Leaving the exhaust valve's servo without cables may result in errors.

13) Reinstall plastics and the brake fluid reservoir



DOMINATOR
EXHAUST SYSTEM